

SCHEMA DI MONTAGGIO / DISASSEMBLAGGIO — ASSEMBLY / DISASSEMBLY INSTRUCTIONS — NOTICE DE MONTAGE / DÉMONTAGE

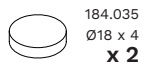

Scrivania per aggancio a mobile
Desk for attachment to cabinet
Bureau avec support pour fixation à meuble

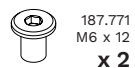

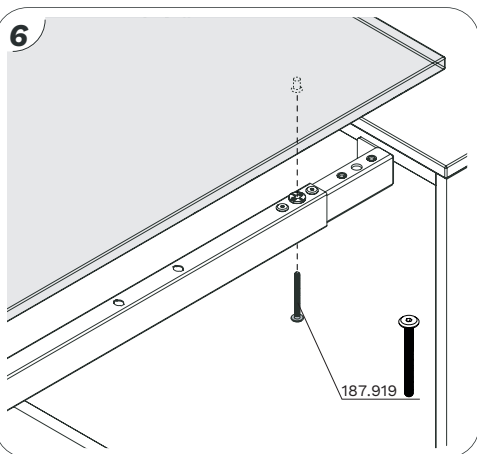
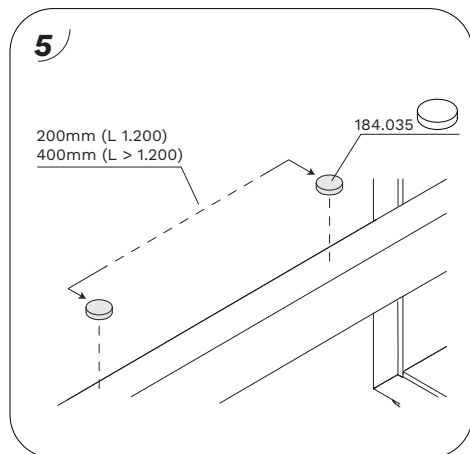
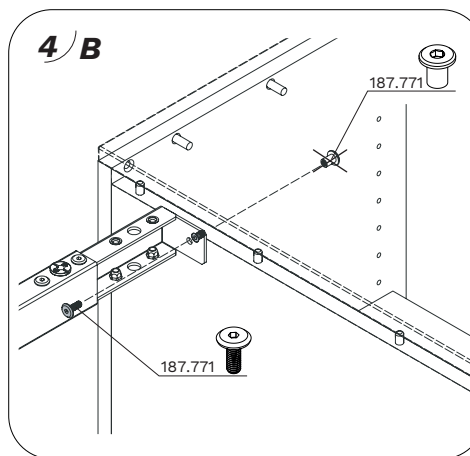
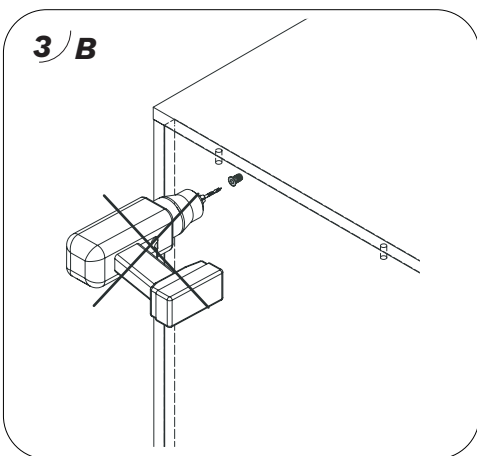
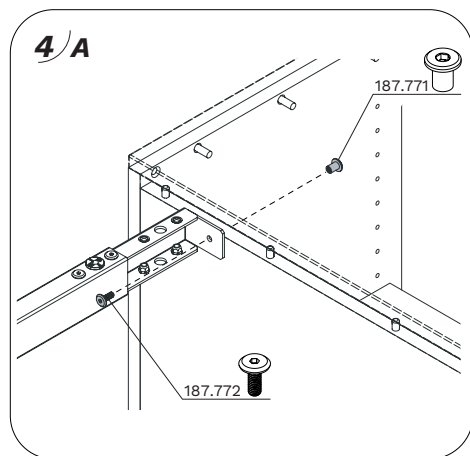
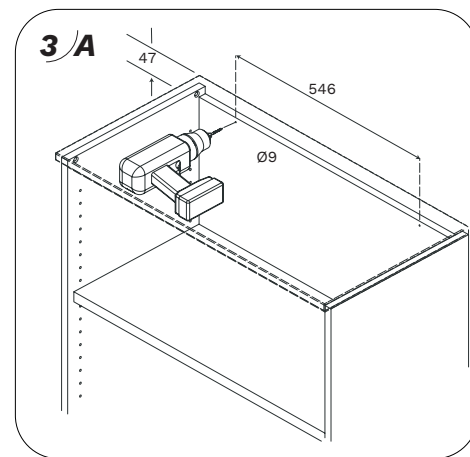
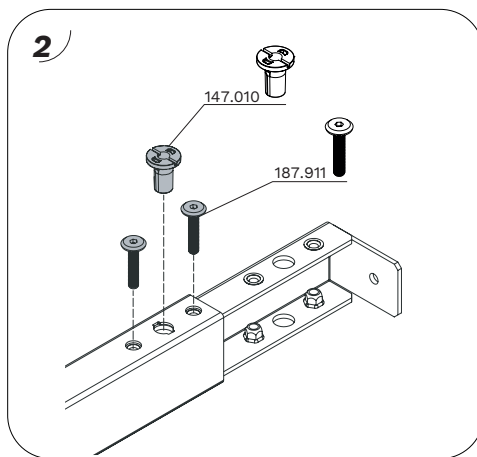
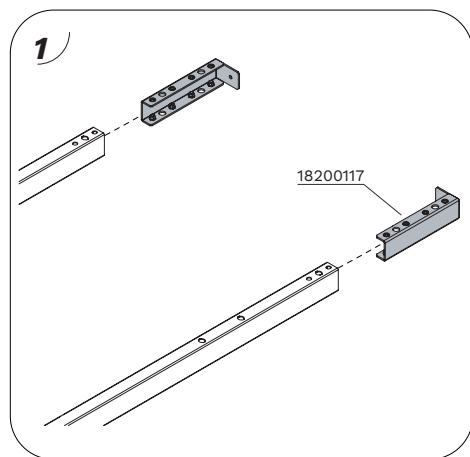
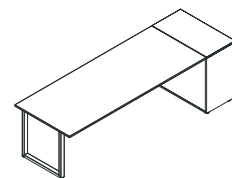

x 2



10min



4 mm



5 mm

SCHEMA DI MONTAGGIO / DISASSEMBLAGGIO — ASSEMBLY / DISASSEMBLY INSTRUCTIONS — NOTICE DE MONTAGE / DÉMONTAGE

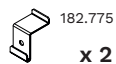

182.775

x 2



187.880

M6 x 8

x 2



187.911

M6 x 30

x 4



187.919

M6 x 65

x 2



184.035

Ø18 x 4

x 2



147.010

x 2



18200117

x 2

Scrivania predisposta per aggancio a libreria Phylo
Desk with support for fixing to bookcase Phylo
Bureau avec support pour fixation à la bibliothèque Phylo

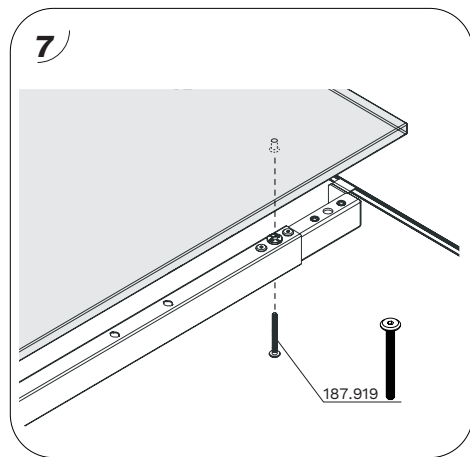
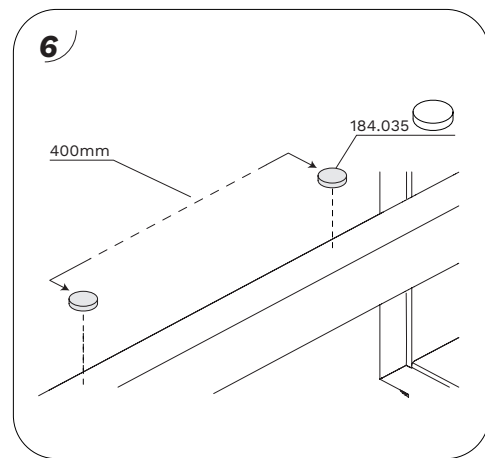
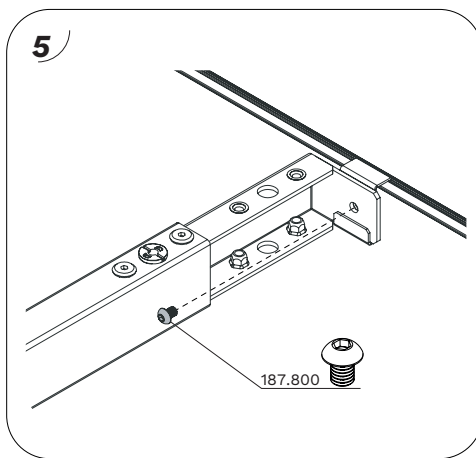
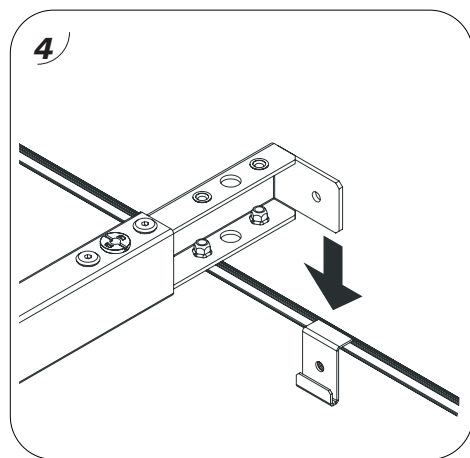
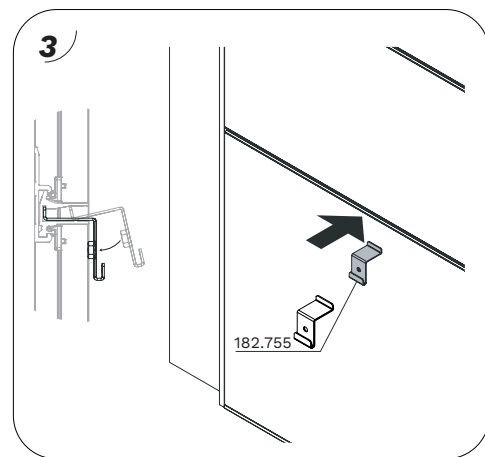
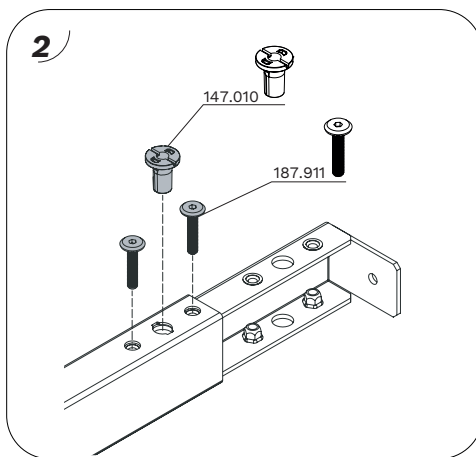
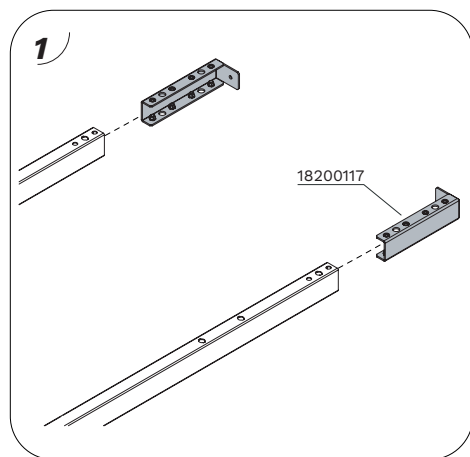
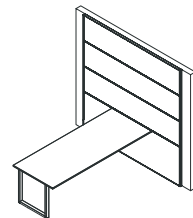

ASSEMBLAGGIO
ASSEMBLY
ASSEMBLÉE

-Per disassemblare il prodotto seguire le istruzioni di assemblaggio a ritroso,
invertendo il senso delle frecce.



DISASSEMBLAGGIO
DISASSEMBLY
DÉMONTAGE

-To disassemble the product, please follow the assembly instructions in the opposite order,
reversing the arrows' direction.

-Pour démonter le produit, suivez les instructions de montage en sens inverse,
en inversant le sens des flèches.